



INSTRUCTIONS FOR: PARTS CLEANING TANK BENCH/ PORTABLE

MODEL No: **SM21.V4**

Thank you for purchasing a Sealey product. Manufactured to a high standard, this product will, if used according to these instructions, and properly maintained, give you years of trouble free performance.



IMPORTANT: PLEASE READ THESE INSTRUCTIONS CAREFULLY. NOTE THE SAFE OPERATIONAL REQUIREMENTS, WARNINGS & CAUTIONS. USE THE PRODUCT CORRECTLY AND WITH CARE FOR THE PURPOSE FOR WHICH IT IS INTENDED. FAILURE TO DO SO MAY CAUSE DAMAGE AND/OR PERSONAL INJURY AND WILL INVALIDATE THE WARRANTY. KEEP THESE INSTRUCTIONS SAFE FOR FUTURE USE.

1. SAFETY

1.1. ELECTRICAL SAFETY.

WARNING! It is the user's responsibility to read, understand and comply with the following:

You must check all electrical equipment and appliances to ensure they are safe before using. You must inspect power supply leads, plugs and all electrical connections for wear and damage. You must ensure the risk of electric shock is minimised by the installation of appropriate safety devices. An RCCB (Residual Current Circuit Breaker) should be incorporated in the main distribution board. We also recommend that an RCD (Residual Current Device) is used with all electrical products. It is particularly important to use an RCD together with portable products that are plugged into an electrical supply not protected by an RCCB.

If in doubt consult a professional electrician. You may obtain a Residual Current Device by contacting your Sealey dealer. **You must** also read and understand the following instructions concerning electrical safety.

1.1.1. The **Electricity At Work Act 1989** requires all portable electrical appliances, if used on business premises, to be tested by a qualified electrician, using a Portable Appliance Tester (PAT), at least once a year.

1.1.2. The **Health & Safety at Work Act 1974** makes owners of electrical appliances responsible for the safe condition of the appliance and the safety of the appliance operator. **If in any doubt about electrical safety, contact a qualified electrician.**

1.1.3. Ensure the insulation on all cables and the product itself is safe before connecting to the mains power supply. See 1.1.1. & 1.1.2. above and use a Portable Appliance Tester (PAT).

1.1.4. Ensure that cables are always protected against short circuit and overload.

1.1.5. Regularly inspect power supply, leads, plugs for wear and damage and all electrical connections to ensure that none are loose.

1.1.6. **Important:** Ensure the voltage marked on the product is the same as the electrical power supply to be used, and check that plugs are fitted with the correct capacity fuse. A 13amp plug may require a fuse smaller than 13amps for certain products (*subject to 1.1.10. below*) see fuse rating at right.

1.1.7. **DO NOT** pull or carry the powered appliance by its power supply lead.

1.1.8. **DO NOT** pull power plugs from sockets by the power cable.

1.1.9. **DO NOT** use worn or damage leads, plugs or connections. Immediately replace or have repaired by a qualified electrician. A U.K. 3 pin plug with ASTA/BS approval is fitted. In case of damage, cut off and fit a new plug according to the following instructions (discard old plug safely).

(UK only - see diagram at right). **Ensure the unit is correctly earthed via a three-pin plug.**

a) **Connect the GREEN/YELLOW earth wire to the earth terminal 'E'.**

b) **Connect the BROWN live wire to live terminal 'L'.**

c) **Connect the BLUE neutral wire to the neutral terminal 'N'.**

After wiring, check that there are no bare wires, that all wires have been correctly connected, that the cable outer insulation extends beyond the cable restraint and that the restraint is tight.

Double insulated products are often fitted with live (BROWN) and neutral (BLUE) wires only. Double insulated products are always marked with this symbol . **To re-wire, connect the brown & blue wires as indicated above. DO NOT connect the brown or blue to the earth terminal.**

1.1.10. Some products require more than a 13amp electrical supply. In such a case, **NO** plug will be fitted. **You must** contact a qualified electrician to ensure a 30amp fused supply is available. We recommend you discuss the installation of an industrial round pin plug and socket with your electrician.

1.1.11. **Cable extension reels.** When a cable extension reel is used it should be fully unwound before connection. A cable reel with an RCD fitted is recommended since any product which is plugged into the cable reel will be protected. The section of the cores of the cable on the reel is important. Use 1.5mm² section cable as a minimum, but to be absolutely sure that the capacity of the cable reel is suitable for this product and for others that may be used in the other output sockets, we recommend the use of 2.5mm² section cable.

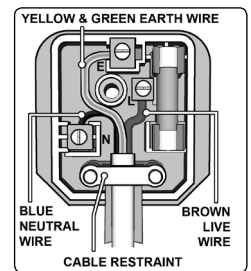

**RECOMMENDED
FUSE RATING: 3AMP**



WARNING - FIRE/EXPLOSION HAZARD

- Use only water soluble solvents. **DO NOT** use flammable solvents.
- Keep ignition sources away from tank and **DO NOT** smoke.
- Use only in a well ventilated area.
- **DO NOT** use tank where there is (or may be) flammable vapours.



WARNING - OPERATOR SAFETY

- Always wear eye/face and hand protection.
- Read and understand instructions before use.
- Clean tank and replace solvent regularly to avoid concentration of contaminants.
- Ensure fusible link (in lid strut) is intact and **never** prop lid open.

Sole UK Distributor, Sealey Group, Bury St Edmunds, Suffolk.

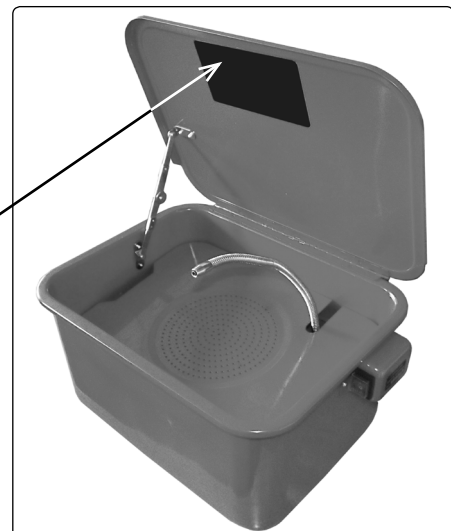

1.2. GENERAL SAFETY

- WARNING!** *Ensure Health & Safety, local authority, and general workshop practice regulations are adhered to when using this equipment.*
- ✓ Familiarise yourself with product application and limitations, as well as the specific potential hazards peculiar to the cleaning tank.
- WARNING!** Disconnect the cleaning tank from the mains power before changing accessories, servicing or performing any maintenance.
- ✓ Maintain the cleaning tank in good condition (use an authorised service agent).
- ✓ Replace or repair damaged parts. *Use genuine parts only. Non-authorised parts may be dangerous and will invalidate the warranty.*
- WARNING! DO NOT** modify the lid or prop it open. Keep the lid and holding screws in place, tight and in good working order.
- ✓ Locate the cleaning tank in an adequate working area for its function. Ensure the cleaning tank is stood on a firm level surface. Keep area clean and tidy and free from unrelated materials. Ensure the area is well ventilated and has adequate lighting.
- ✓ Keep the cleaning tank away from heat sources such as heater, sparks, open flames etc.
- ✓ Keep the tank clean. Remove and clean the filter regularly for best and safest performance.
- ✓ Ensure there are no flammable or combustible materials near the work area.
- WARNING!** Always wear approved eye or face protection when operating the cleaning tank.
- ✓ Remove ill fitting clothing. Remove ties, watches, rings and other loose jewellery, and contain long hair.
- ✓ Wear appropriate protective clothing.
- ✓ Maintain correct balance and footing. Ensure the floor is not slippery and wear non-slip shoes.
- ✓ Keep children and unauthorised persons away from the working area.
- ✓ Avoid accidental starting of the cleaning tank. Ensure that it is unplugged from the mains supply when not in use.
- ✓ In case of fire in parts unit, close the lid, do not attempt to remove parts, or the cleaning tank.
- x **DO NOT** use the cleaning tank for any purpose other than for which it is designed.
- x **DO NOT** use cleaning tank in wet or damp locations or areas where there is condensation.
- x **DO NOT** use the cleaning tank where there are flammable liquids, solids or gases.
- x **DO NOT** allow untrained persons to operate the cleaning tank.
- x **DO NOT** over fill the cleaning tank with solvent. Full capacity should be just below the parts tray.
- x **DO NOT** operate the cleaning tank if any parts are missing or damaged as this may cause failure or possible personal injury.
- x **DO NOT** modify or jam the cleaning tank lid open. Retain the lid open by use of the attached elbow strut only.
- x **DO NOT** use any solvent with a flash point below 105°F. Use only Sealey solvent, contact your local Sealey dealer for details.
- x **DO NOT** leave the cleaning tank operating unattended.
- x **DO NOT** operate the cleaning tank when you are tired, under the influence of alcohol, drugs or intoxicating medication.
- x The tank is not suitable for paint thinners, gun wash or air drying.
- ✓ When not in use switch the cleaning tank off, remove plug from the power supply.
- ✓ Dispose of waste liquids in accordance with local authority regulations.
- WARNING! DO NOT** allow uncontrolled discharge of fluids thus polluting the environment.

2. INTRODUCTION

One-piece tank with triple baked finish and fully sealed magnetic drive pump unit with replaceable impeller. Smaller capacity tank is suitable for bench-top mounting. Lid features self-latching fusible link which enables the lid to shut automatically in the event of a fire. Recirculated fluid is filtered before entering the pump and is directed over the workpiece with a flexible metal delivery nozzle. Removable shelf included.

3. SPECIFICATION

Model No:	SM21.V4
Power Supply:	230V
Motor Power:	26W
Tank Height/Width/Length:	210/290/395mm
Overall Height:	225mm
Minimum Working Capacity:	7ltr
Maximum Working Capacity:	15ltr
Pump Output/Hr:90ltr
Weight:	6.88kg

4. OPERATION

- WARNING! Ensure that you have read, understood and apply the chapter 1 safety instructions before using the cleaning tank.**
- 4.1. Check that the washer power switch is in the off position, and that the unit is unplugged from the mains power supply.
- 4.2. Check that the lid will close under its own weight by opening fully and releasing. Free up if necessary.
- 4.3. Open the lid fully and ensure the "over centre" link engages (fig.1 and fig.2). Fill the tank to appropriate capacity; between a minimum of 7ltrs and a maximum of 15ltrs with a Sealey solvent or a general purpose degreaser. Contact your local Sealey dealer for supply. **DO NOT** use any other type of solvent. **CAUTION! Ensure that you follow any instructions provided with the solvent.**
- 4.4. If fitted, remove the internal tray to ensure the pump is immersed correctly in the solvent. Replace the internal tray.
- 4.5. Plug the unit into the mains power supply and switch the unit on (fig.3). Check that the solvent flows freely through the flexible spout.
- 4.6. Place parts to be cleaned onto the internal cleaning tray. Ensure any splash back stays inside the tank. For ground-in dirt etc, leave the parts to soak in the bottom of the tank. Brush parts with the cleaning brush if required. Turn off the pump and leave the parts to drain on the shelf.
- 4.7. When complete, turn the washer off and unplug from the mains power supply.
- WARNING! DO NOT** allow uncontrolled discharge of fluids, thus polluting the environment. Dispose of waste liquids according to local authority regulations.
- 4.8. Keep the cleaning tank clean. Remove and clean the filter regularly (fig.4) for the best and safest performance.
- IMPORTANT!** This cleaning tank has an anti-fire device built into it (fig.1 and fig.2). In the event of a fire and subsequent increase in temperature locally, the low melting point solder in the fusible links turns from solid to liquid allowing the lid to close under gravity. **DO NOT** prop the lid open with anything other than the fitted fused linkage. Use your finger (fig.2) to ensure full engagement. Once actuated, the fire detection device cannot be re-used and must be replaced. When cleaning parts ensure that nothing in the tank, including the parts basket and the flexible spout, is in a position that would prevent the lid from closing fully, if and when the fusible link activates.

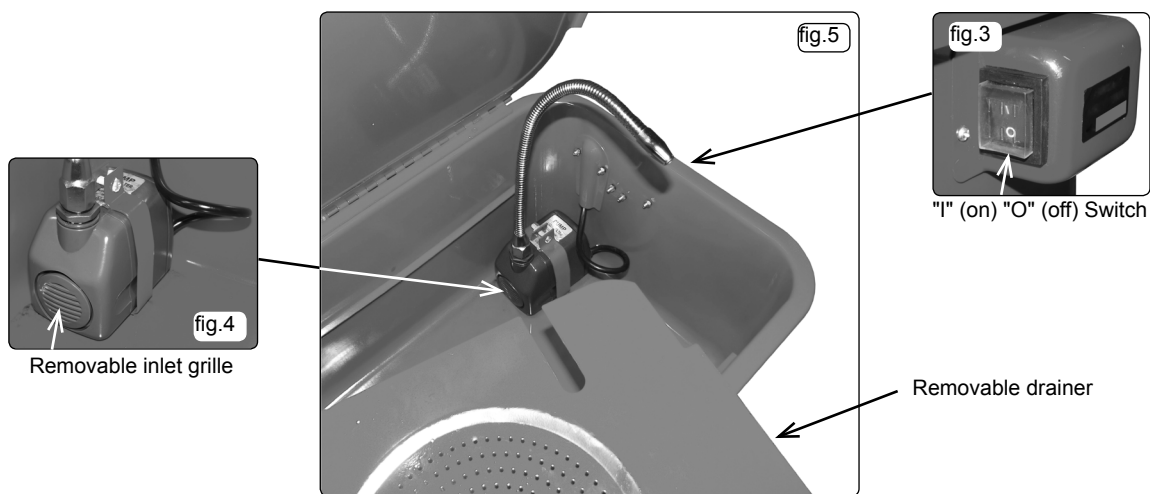
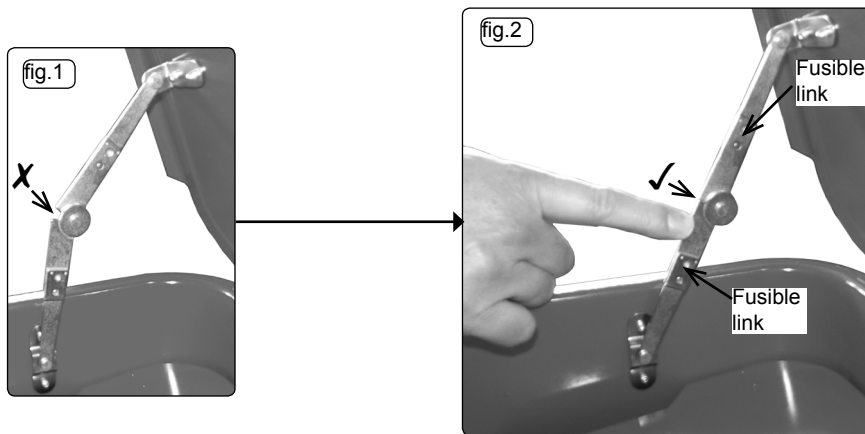

5. MAINTENANCE

- 5.1. Check that the cleaning tank power switch is in the off position, and that the unit is unplugged from the mains power supply before any maintenance activity.
- 5.2. Check that the lid will close under its own weight by opening fully and releasing. Free up if necessary.
- 5.3. Keep the cleaning tank and drainer clean, see fig.5 for ease of access.
- 5.4. Remove the inlet grille and clean regularly (fig.4) for the best and safest performance.
- 5.5. Replenish the cleaning agent when it has become contaminated. This must be at user discretion.

Parts support is available for this product.

To obtain parts listing and/or diagram, please log on to www.sealey.co.uk or telephone 01284 757500.

Environmental Protection



Recycle unwanted materials instead of disposing of them as waste. All tools, accessories and packaging should be sorted, taken to a recycling centre and disposed of in a manner which is compatible with the environment.



WEEE Regulations

Dispose of this product at the end of its working life in compliance with the EU Directive on Waste Electrical and Electronic Equipment (WEEE). When the product is no longer required, it must be disposed of in an environmentally protective way. Contact your local solid waste authority for recycling information.

NOTE: It is our policy to continually improve products and as such we reserve the right to alter data, specifications and component parts without prior notice.

IMPORTANT: No liability is accepted for incorrect use of this product.

WARRANTY: Guarantee is 12 months from purchase date, proof of which will be required for any claim.

INFORMATION: For a copy of our latest catalogue and promotions call us on 01284 757525 and leave your full name and address, including postcode.



SEALEY

Sole UK Distributor, Sealey Group,
Kempson Way, Suffolk Business Park,
Bury St. Edmunds, Suffolk,
IP32 7AR



01284 757500



01284 703534



www.sealey.co.uk



sales@sealey.co.uk