



300W HOT AIR REWORK STATION

MODEL NO: **SD007**

Thank you for purchasing a Sealey product. Manufactured to a high standard, this product will, if used according to these instructions, and properly maintained, give you years of trouble free performance.

IMPORTANT: PLEASE READ THESE INSTRUCTIONS CAREFULLY. NOTE THE SAFE OPERATIONAL REQUIREMENTS, WARNINGS & CAUTIONS. USE THE PRODUCT CORRECTLY AND WITH CARE FOR THE PURPOSE FOR WHICH IT IS INTENDED. FAILURE TO DO SO MAY CAUSE DAMAGE AND/OR PERSONAL INJURY AND WILL INVALIDATE THE WARRANTY. KEEP THESE INSTRUCTIONS SAFE FOR FUTURE USE.



Refer to instructions



Indoor use only



Hot surfaces

1. SAFETY

1.1. ELECTRICAL SAFETY

- WARNING!** It is the responsibility of the owner and the operator to read, understand and comply with the following: You must check all electrical products, before use, to ensure that they are safe. You must inspect power cables, plugs, sockets and any other connectors for wear or damage. You must ensure that the risk of electric shock is minimised by the installation of appropriate safety devices. A Residual Current Circuit Breaker (RCCB) should be incorporated in the main distribution board. You must also read and understand the following instructions concerning electrical safety.
- ✓ Ensure that cables are always protected against short circuit and overload.
- ✓ Regularly inspect power supply cables and plugs for wear or damage and check all connections to ensure that none are loose.
- ✓ Ensure that the voltage marked on the appliance matches the power supply to be used and that the plug is fitted with the correct fuse - see fuse rating at right.
- ✗ **DO NOT** use worn or damaged cables, plugs or connectors. Have any faulty item repaired or replaced immediately by a competent electrician.
- ✓ It is recommended that this device is wired directly to a fused isolator switch. If, however, a plug is fitted, the following applies:
- ✓ Fit a new plug according to the following instructions (UK only).
 - a) Connect the GREEN/YELLOW earth wire to the earth terminal 'E'.
 - b) Connect the BROWN live wire to the live terminal 'L'.
 - c) Connect the BLUE neutral wire to the neutral terminal 'N'.
 - d) After wiring, check that there are no bare wires, that all wires have been correctly connected, that the cable restraint is tight.

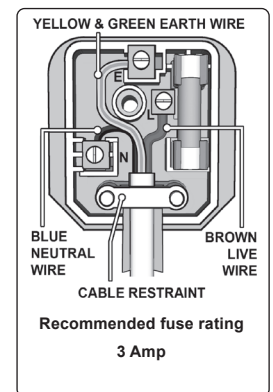

1.2. GENERAL SAFETY

- WARNING!** Ensure Health & Safety, local authority, and general workshop practice regulations are adhered to when using this equipment.
 - ✓ This tool must be placed on its stand when not in use.
 - ✓ Caution-High Temperature Operation
 - ✗ **DO NOT** use the Surface Mounted Device unit near ignitable gases, paper, or other inflammable materials.
 - ✓ The nozzle air is extremely hot and can cause painful burns. Never touch the heater pipe or allow the heated air to blow against your skin.
 - ✗ **DO NOT** disassemble the product.
 - ✓ Disconnect the plug when you don't use the unit for a long time.
 - ✓ When the power cord is connected into the power supply, the unit has a little flow of electricity, even the Power Switch is in off position. So then you don't use the unit for a long time, disconnect the plug.
- This appliance can be used by children aged from 8 years and above and persons with reduced physical, sensory or mental capabilities or lack of experience and knowledge if they have been given supervision or instruction concerning use of the appliance in a safe way and understand the hazards involved. Children shall not play with the appliance. Cleaning and user maintenance shall not be made by children without supervision.

2. INTRODUCTION

300W Hot air rework station with automatic cooling system. LED digital display, showing current temperature and status. MCU confirms fast heat up, accurate & stable control on temperature. Temperature Range: 100-500°C. Suitable for desoldering work on various components such as SOIC, CHIP, QFP, PLCC and BGA. Includes three nozzles.

3. SPECIFICATION

MODEL NO:.....SD007
 Brand: Sealey
 Electrical Plug Type: 3-Pin BS
 Frequency:.....50Hz
 Power:.....300W

4. OPERATION

4.1. ATTACHING AND REMOVING THE NOZZLE

- × **DO NOT** press the Nozzle or pull on the edge of the Nozzle by pliers.
- 4.1.1. Push the nozzles into position. Note: Try to use nozzles with a larger diameter.
- **WARNING!** Wait for nozzle to completely cool before removing it.

4.2. OVERHEAT PROTECTION

- 4.2.1. Power will automatically be off when the unit exceeds a certain temperature. Once the temperature has dropped to a safety level, power will automatically be turned on.
- 4.3. Connect the mains plug to a socket.
- 4.4. Turn on the power switch, set the air flow rate and temperature and put the unit on the rack.
- 4.5. Put the nozzle on the pins of the Integrated Circuit, so that the hot air can melt the solder tin on the Integrated Circuit pin, then use the tweezers to remove the Integrated Circuit.
- 4.6. After use, turn off the power switch, remove the plug from the power supply and allow to cool before storing in a safe place out of children's reach.
- 4.7. The display and temperature setting

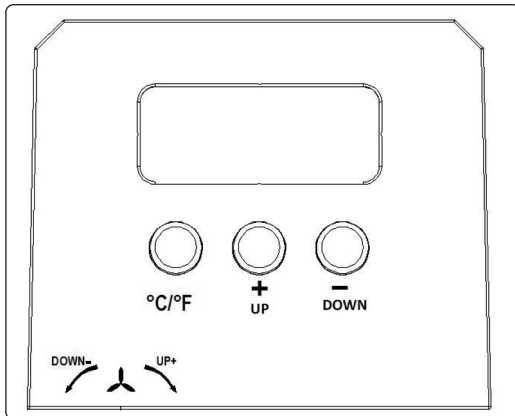

- 4.8. Press the button “+(UP)” or “-(DOWN)” to adjust the temperature.
Short press, the set-point will change $\pm 1^{\circ}$
Long press, the set-point will change quickly and reach your target temperature.
 - 4.9. “°C/ °F” is the transfer button between °C/ °F
The default unit is °C, press the “°C/ °F” button to make change between °C and °F.
 - 4.10. The air flow rate can be adjusted by the knob under the fan symbol.
When you rotate the knob to the DOWN - side, the air flow slows down;
When you rotate the knob to the UP + side, the air flow goes up;
 - 4.11. This unit has sleep function.
When you put the air pump on the rack, the item will stop heating, And the display shows “SLP” (means SLEEP), when you pick up the air pump , the item will get back to the set temperature.
 - 4.12. **WASHING**
4.12.1. When de-solder is completed, please wash away the flux.
- NOTE:** While you de-solder by Hot air, the defects such as solder balls, solder bridges might occur. We recommend you to examine the condition of the soldering.



ENVIRONMENT PROTECTION

Recycle unwanted materials instead of disposing of them as waste. All tools, accessories and packaging should be sorted, taken to a recycling centre and disposed of in a manner which is compatible with the environment. When the product becomes completely unserviceable and requires disposal, drain any fluids (if applicable) into approved containers and dispose of the product and fluids according to local regulations.



WEEE REGULATIONS

Dispose of this product at the end of its working life in compliance with the EU Directive on Waste Electrical and Electronic Equipment (WEEE). When the product is no longer required, it must be disposed of in an environmentally protective way. Contact your local solid waste authority for recycling information.

Note: It is our policy to continually improve products and as such we reserve the right to alter data, specifications and component parts without prior notice.

Important: No Liability is accepted for incorrect use of this product.

Warranty: Guarantee is 12 months from purchase date, proof of which is required for any claim.

Sealey Group, Kempson Way, Suffolk Business Park, Bury St Edmunds, Suffolk. IP32 7AR



01284 757500



01284 703534



sales@sealey.co.uk



www.sealey.co.uk