

Issue: 1  
 Date Issued: 16/03/2009

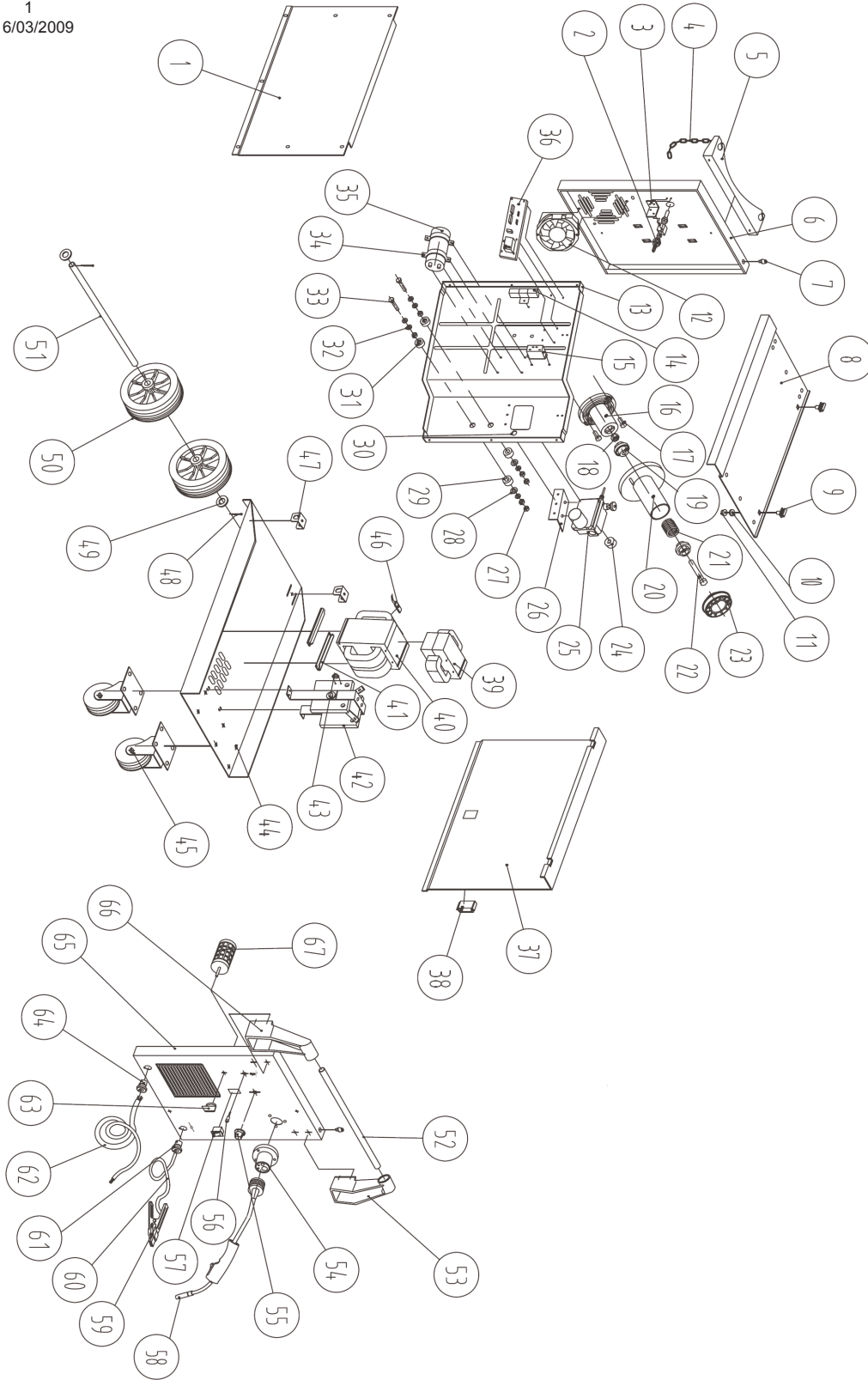

**NOTE:** It is our policy to continually improve products and as such we reserve the right to alter data, specifications and component parts without prior notice.

**IMPORTANT:** No liability is accepted for incorrect use of product.

**WARRANTY:** Guarantee is 12 months from purchase date, proof of which will be required for any claim.

**INFORMATION:** For a copy of our latest catalogue and promotions call us on 01284 757525 and leave your full name and address, including postcode.



PARTS LIST FOR:  
**PROFESSIONAL GAS/NO-GAS  
MIG WELDER 210AMP WITH EURO TORCH**  
MODEL: **MIGHTYMIG210**

Issue: 1  
Date Issued: 16/03/2009

ITEM	PART NO	DESCRIPTION	ITEM	PART NO	DESCRIPTION
1	M/MIG210.01	Side Panel	36	M/MIG210.36	Wire Feed PCB
2	M/MIG210.02	Valve Assembly	37	M/MIG210.37	Access Panel
3	M/MIG210.03	Valve Bracket	38	M/MIG210.38	Latch
4	M/MIG210.04	Chain	39	M/MIG210.39	Filter Reactor
5	M/MIG210.05	Gas Bottle Support	40	M/MIG210.40	Main Transformer
6	M/MIG210.06	Back Panel	41	M/MIG210.41	Transformer Support
7	M/MIG210.07	Rubber Support	42	M/MIG210.42	Rectifier Support
8	M/MIG210.08	Top Panel	43	M/MIG210.43	Switch
9	M/MIG210.09	Hinge	44	M/MIG210.44	Bottom Panel
10	M/MIG210.10	Rubber Washer	45	M/MIG210.45	Caster Wheel
11	M/MIG210.11	Nut, M8	46	M/MIG210.46	Thermal Switch
12	M/MIG210.12	Fan	47	M/MIG210.47	Axle Bracket
13	M/MIG210.13	Inner Panel	48	M/MIG210.48	pin
14	M/MIG210.14	Resistance	49	M/MIG210.49	Washer
15	M/MIG210.15	Relay	50	M/MIG210.50	Wheel
16	M/MIG210.16	Axle	51	M/MIG210.51	Axle
17	M/MIG210.17	Bolt M8 x 25mm	52	M/MIG210.52	Handle
18	M/MIG210.18	Nut M10	53	M/MIG210.53	Handle Support (Right)
19	M/MIG210.19	Plastic Knob	54	M/MIG210.54	Toch Holder
20	M/MIG210.20	Spool Holder	55	M/MIG210.55	Speed Control Knob
21	M/MIG210.21	Spring	56	M/MIG210.56	Overload Indicator Light
22	M/MIG210.22	Bolt, M10x80	57	M/MIG210.57	ON/OFF Switch
23	M/MIG210.23	Retainer	58	M/MIG210.58	Welding Torch (MB15)
24	M/MIG210.24	Wire Feed Roller	59	M/MIG210.59	Clamp (Earth)
25	M/MIG210.25	Wire Feed Motor	60	M/MIG210.60	Earth Cable
26	M/MIG210.26	Wire Feeder Support	61	M/MIG210.61	Cable Tip
27	M/MIG210.27	Nut M8	62	M/MIG210.62	Line Cable
28	M/MIG210.28	Washer	63	M/MIG210.63	Voltage Control Knob
29	M/MIG210.29	Insulating Washer	64	M/MIG210.64	Cable Tip
30	M/MIG210.30	Rubber Ring	65	M/MIG210.65	Front Panel
31	M/MIG210.31	Insulating Washer	66	M/MIG210.66	Handle Support (Left)
32	M/MIG210.32	Washer	67	M/MIG210.67	Voltage Control Switch
33	M/MIG210.33	Bolt M8 x 55mm			
34	M/MIG210.34	Capacitor Bracket			
35	M/MIG210.35	Capacitor			

**NOTE:** It is our policy to continually improve products and as such we reserve the right to alter data, specifications and component parts without prior notice.

**IMPORTANT:** No liability is accepted for incorrect use of product.

**WARRANTY:** Guarantee is 12 months from purchase date, proof of which will be required for any claim.

**INFORMATION:** For a copy of our latest catalogue and promotions call us on 01284 757525 and leave your full name and address, including postcode.



Sole UK Distributor  
Sealey Group,  
Bury St. Edmunds, Suffolk.



01284 757500



01284 703534



[www.sealey.co.uk](http://www.sealey.co.uk)



[sales@sealey.co.uk](mailto:sales@sealey.co.uk)